

COMPONENTI CASSE MOBILI E SCARRABILI

Sistema Schneider - A norme DIN

Operazioni per la movimentazione di una cassa mobile con messa a terra

Rilasciare svitando i twist-lock anteriori e posteriori

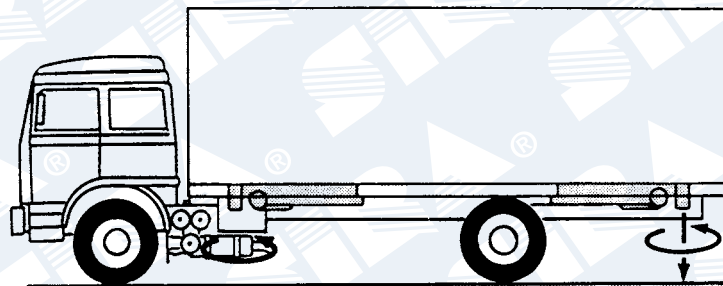

Togliere il dispositivo di sicurezza alla gamba di sostegno. Farla ruotare verso il basso fino al perfetto posizionamento della stessa. Azionare tramite comando pneumatico il sollevamento posteriore.

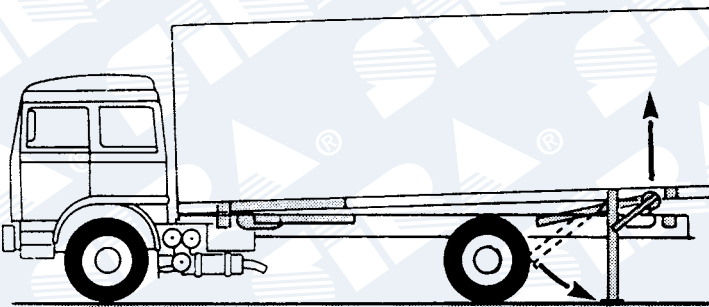

Ripetere le operazioni come sopra riportato nella parte anteriore.

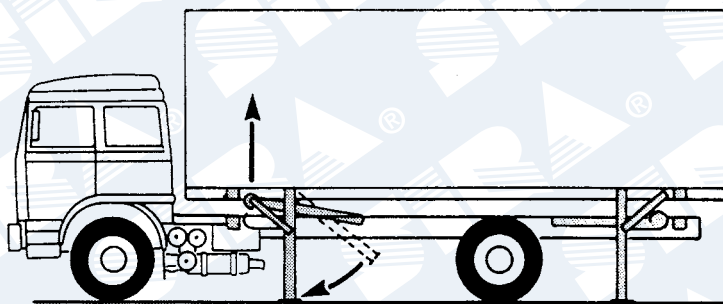

Operazione conclusa. Il veicolo può uscire.

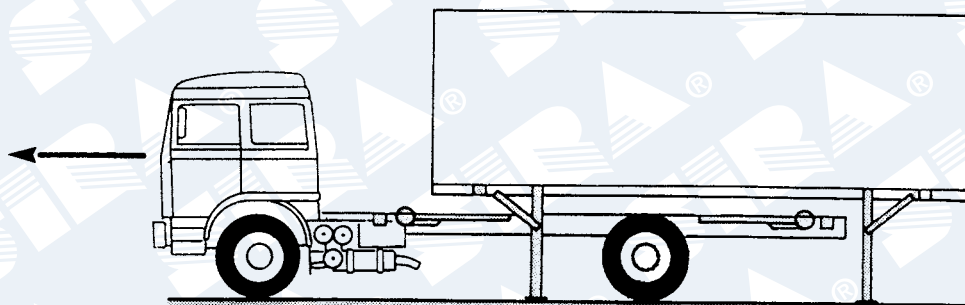

COMPONENTI CASSE MOBILI E SCARRABILI

Sistema Schneider - A norme DIN

Dimensioni principali per casse mobili a norma

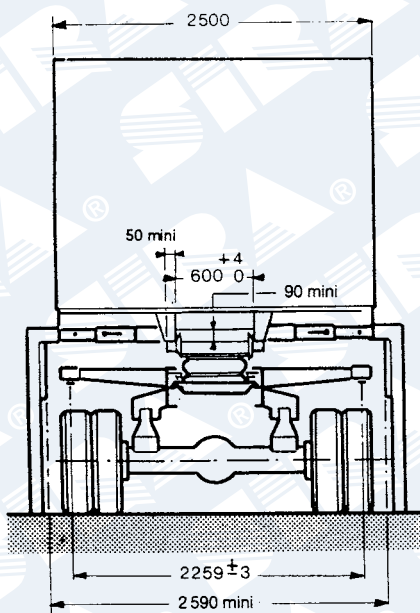
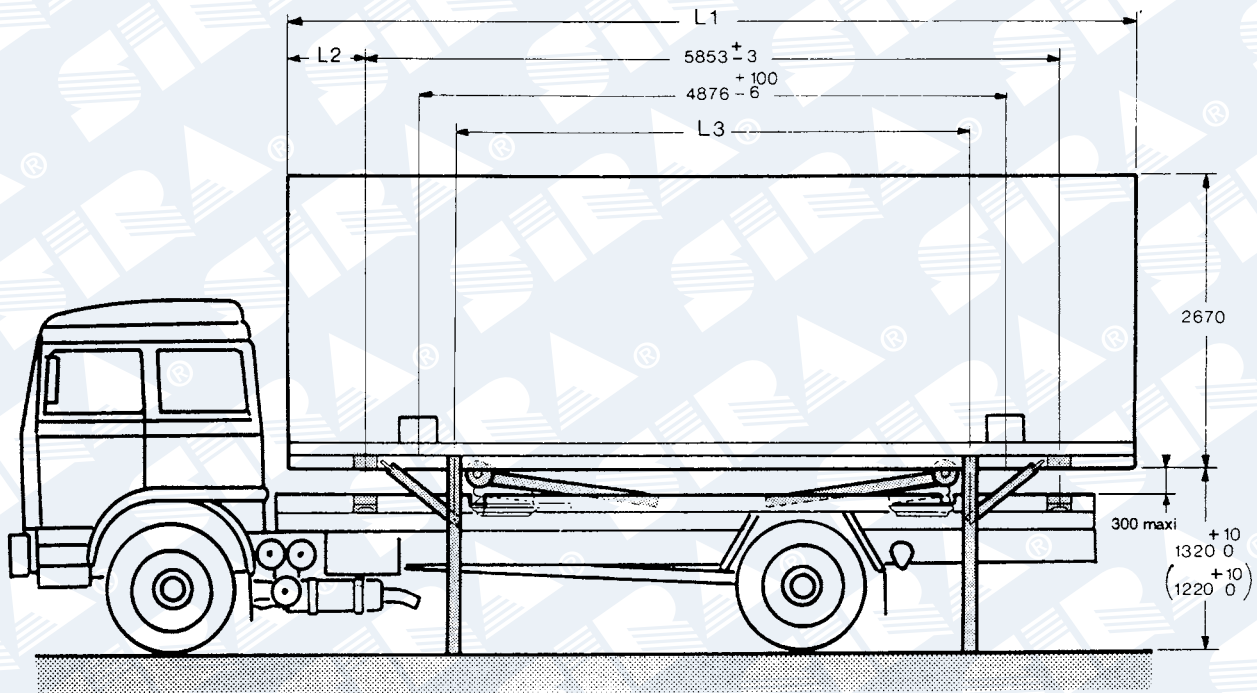

L1 (mm)	L2 (mm)	L3 (mm)
$7\ 150 - \frac{0}{20}$	$648,5 - \frac{0}{3}$	$4\ 354^{+5}$
$7\ 420 - \frac{0}{20}$	$783,5 - \frac{0}{3}$	$5\ 523^{+5}_{-40}$
$7\ 820 - \frac{0}{20}$	$983,5 - \frac{0}{3}$	$5\ 523^{+5}_{-40}$

COMPONENTI CASSE MOBILI E SCARRABILI

Sistema Schneider - A norme DIN

Disposizione dei particolari sul telaio della cassa mobile

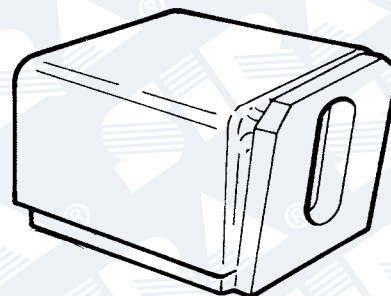
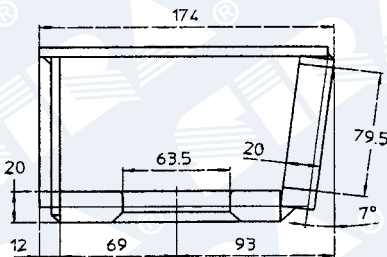
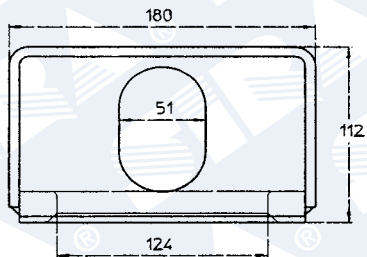
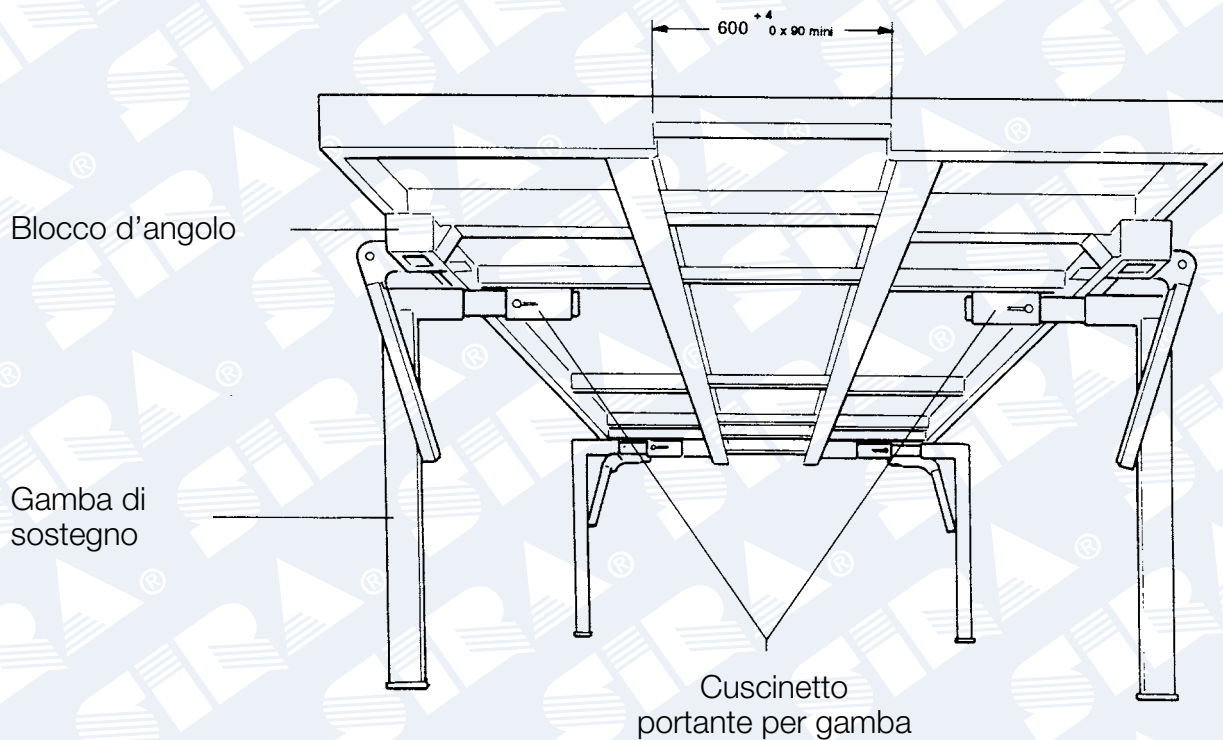

BLOCCO D'ANGOLO
INCLINATO

W 20070

7,20 kg

COMPONENTI CASSE MOBILI E SCARRABILI

Sistema Schneider - A norme DIN

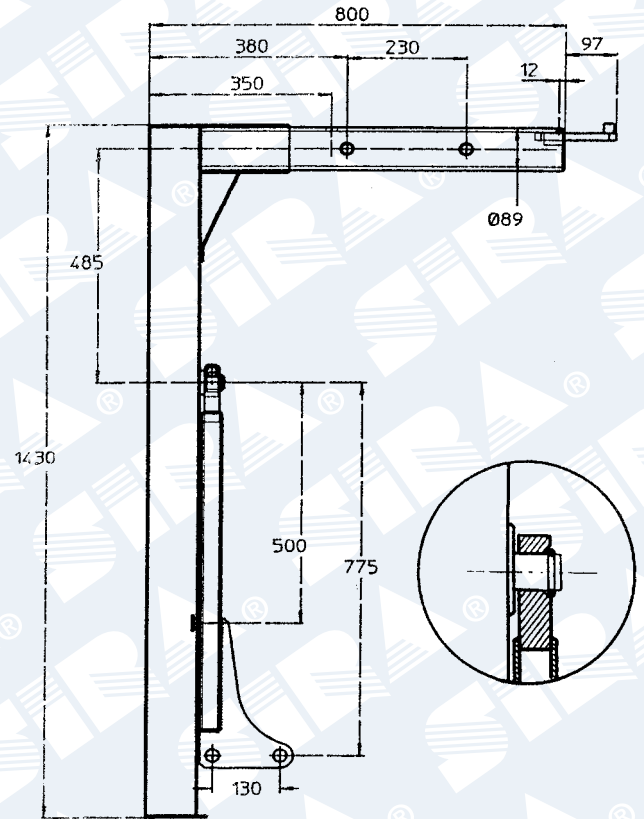
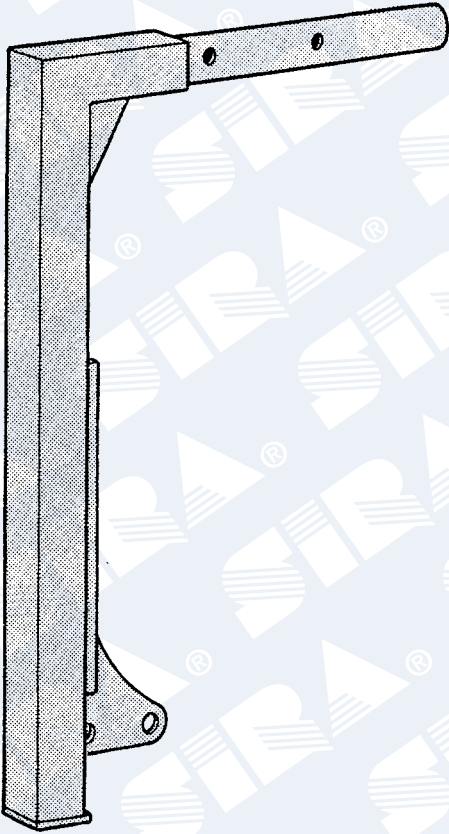

GAMBA DI SOSTEGNO
CON PUNTELLO

W 20000

Portata 16 t

41 kg

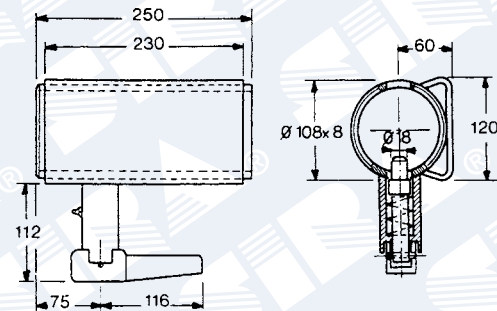
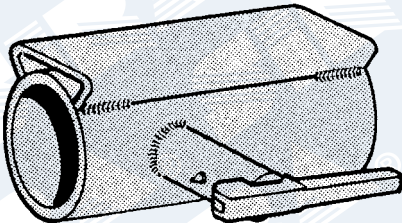

CUSCINETTO PORTANTE
PER GAMBA DESTRO

W 20040

8,10 kg

CUSCINETTO PORTANTE
PER GAMBA SINISTRO

W 20030

8,10 kg

COMPONENTI CASSE MOBILI E SCARRABILI

Sistema Schneider - A norme DIN



GAMBA DI SOSTEGNO
CON PUNTELLO TELESCOPICA

W 20010

Portata 16 t

43 kg

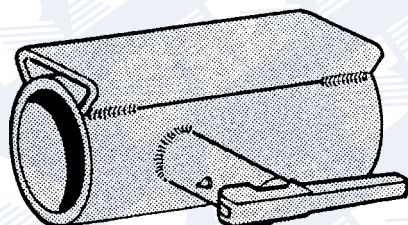
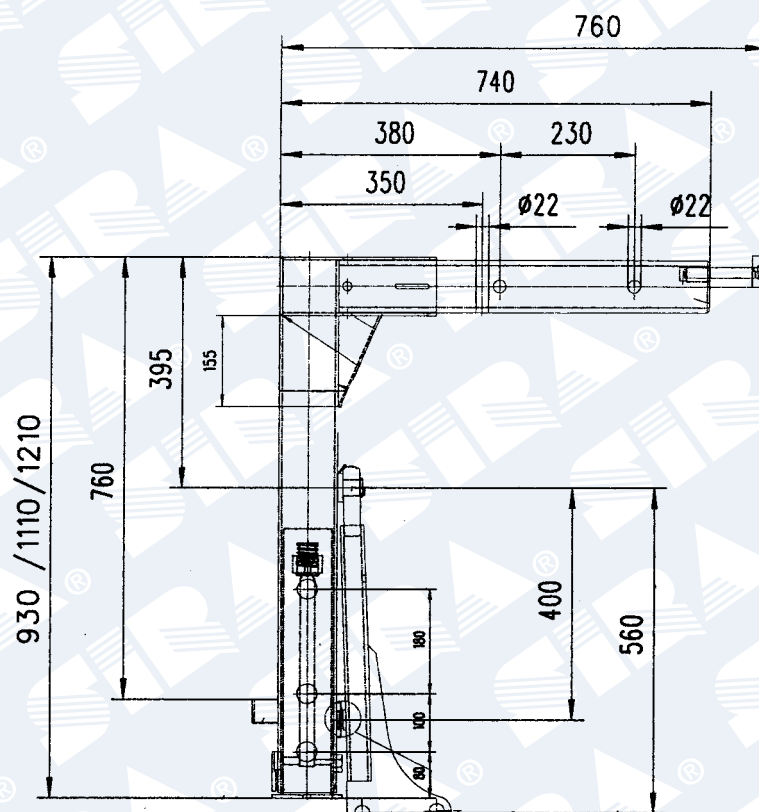

CUSCINETTO PORTANTE
PER GAMBA DESTRO

W 20040

8,10 kg

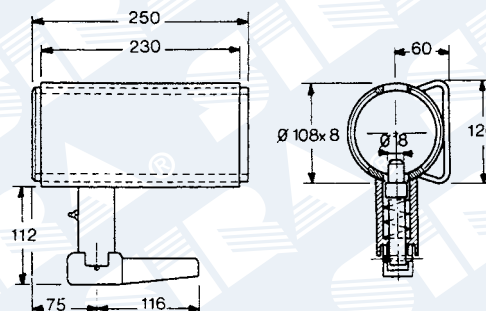

CUSCINETTO PORTANTE
PER GAMBA SINISTRO

W 20030

8,10 kg

COMPONENTI CASSE MOBILI E SCARRABILI

Sistema Schneider - A norme DIN

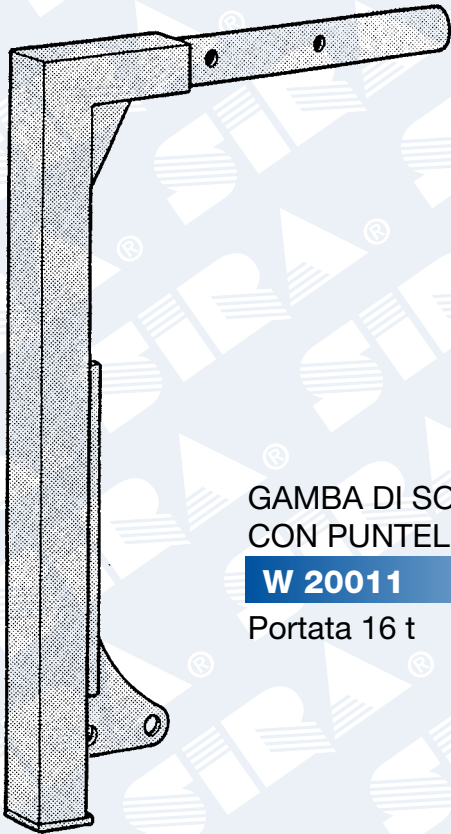

GAMBA DI SOSTEGNO
CON PUNTELLO RIBASSATA

W 20011

Portata 16 t

37 kg

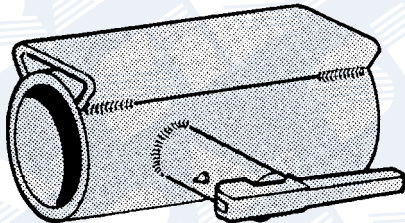
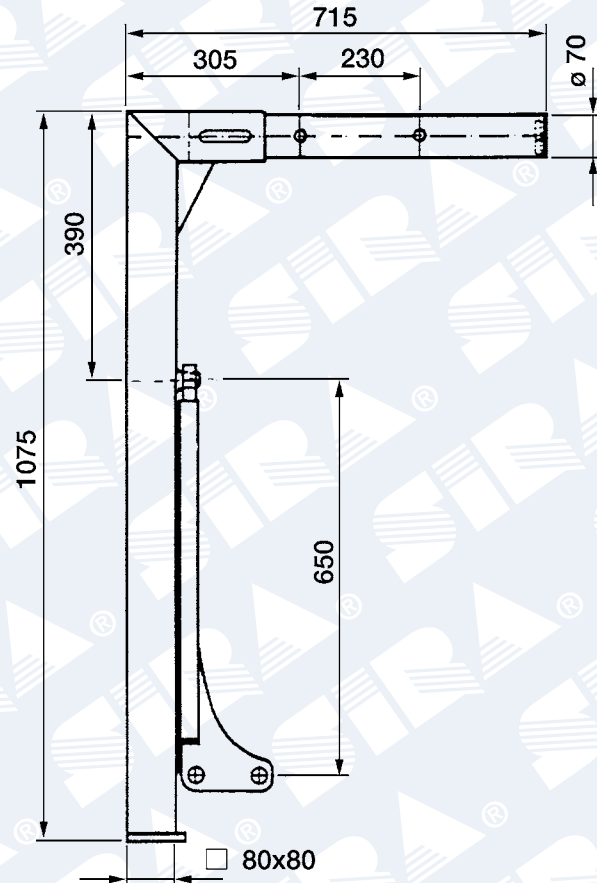

CUSCINETTO PORTANTE
PER GAMBA DESTRO

W 20012

6,60 kg

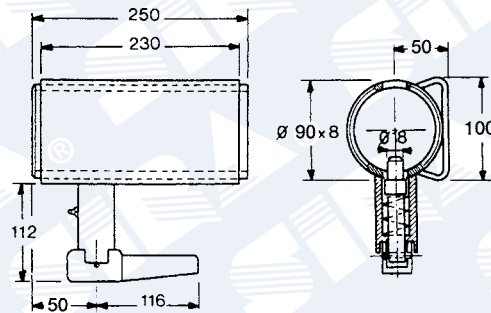

CUSCINETTO PORTANTE
PER GAMBA SINISTRO

W 20013

6,60 kg

COMPONENTI CASSE MOBILI E SCARRABILI

Sistema Schneider - A norme DIN

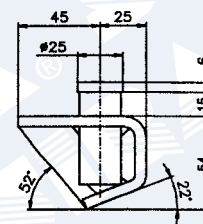
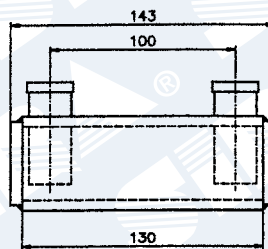
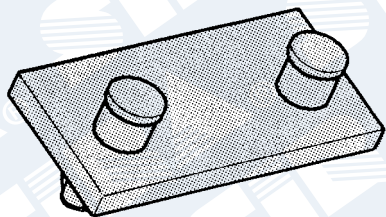

SUPPORTO PIASTRA
CON PERNI

W 20050

1,15 kg

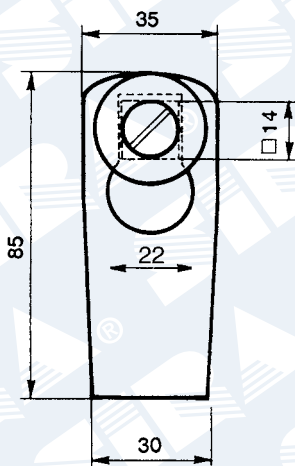
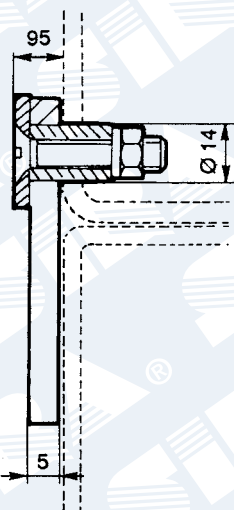

PIASTRINA DI SECONDA
SICUREZZA

W 20080

0,15 kg

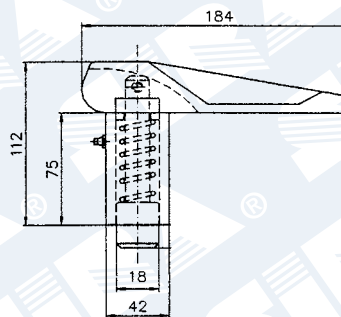

MANIGLIA RICAMBIO
CUSCINETTO

W 20190

1,40 kg

COMPONENTI CASSE MOBILI E SCARRABILI

Sistema Schneider - A norme DIN

Traverse con Twist-Lock integrati

TRAVERSA PER CASSE MOBILI
RIBASSATA

W 20201

Portata 18 t

70 kg

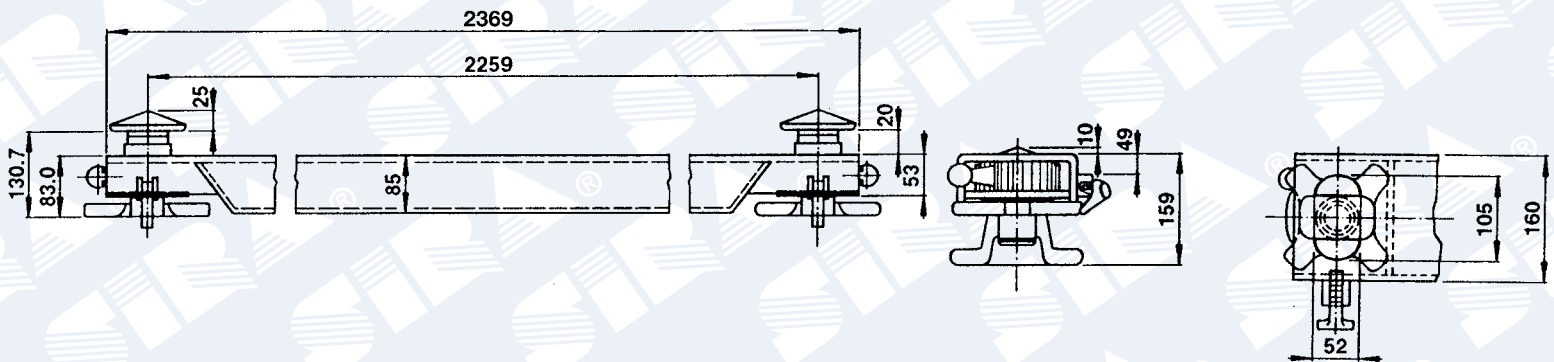

TRAVERSA PER CASSE MOBILI

W 20203

Portata 32 t

80 kg

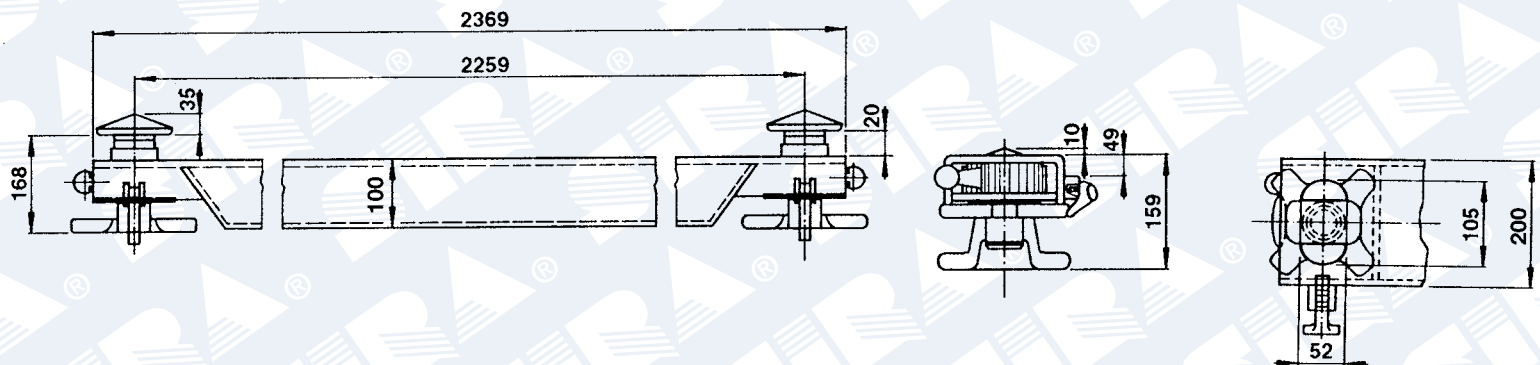

TRAVERSA PER CASSE MOBILI

W 20202

Portata 32 t

96 kg

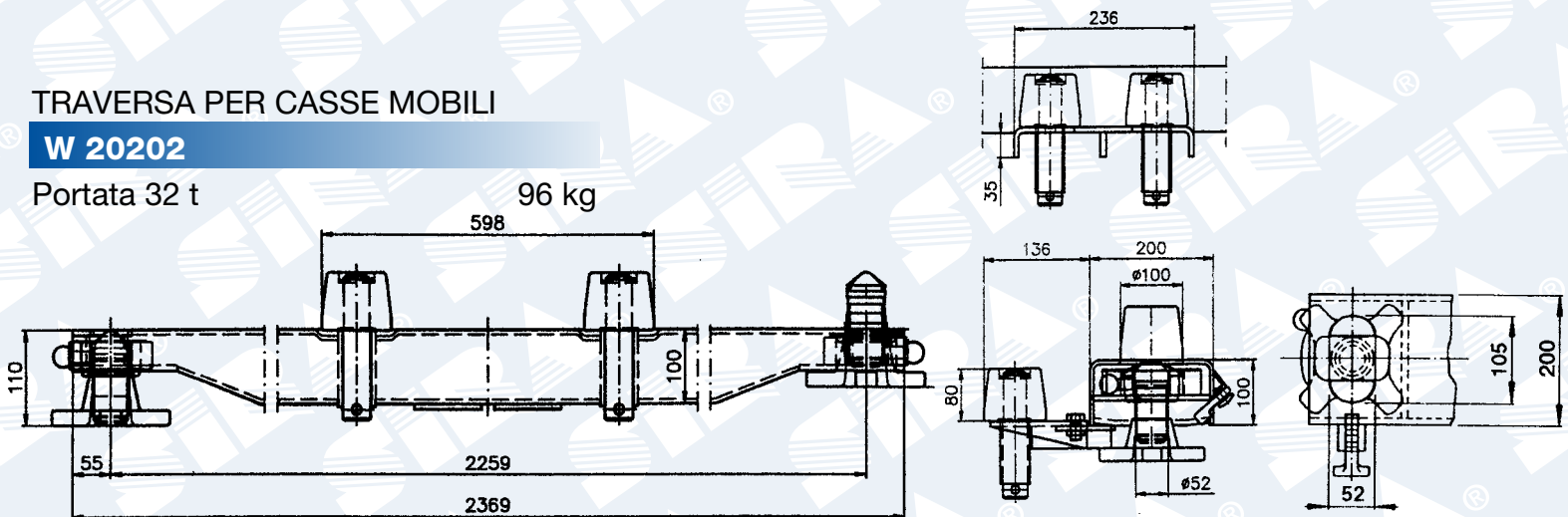

COMPONENTI CASSE MOBILI E SCARRABILI

Componenti varie Pezzi di ricambio per twist lock e traverse Schneider

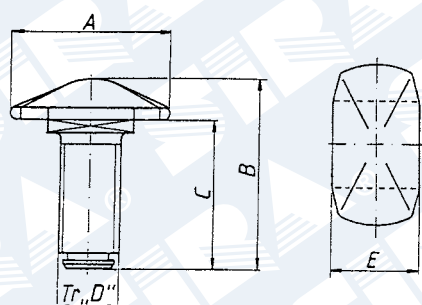

PERNO TENDITORE

ARTICOLO	A mm	B mm	C mm	D _{TR} mm	E mm	PER ARTICOLI
W 20214	97	155	120	38x4	47	W 20130
W 20204	99	129	104	52x5	54	W 20201 W 20203 W 20131

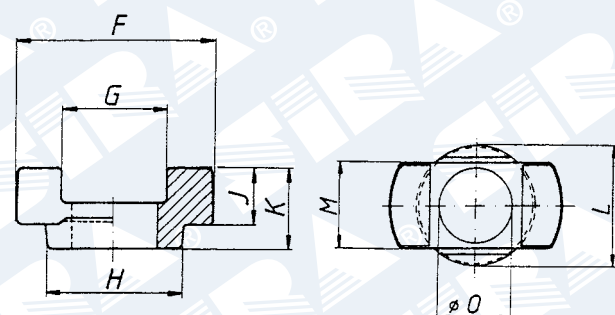

PEZZO GUIDA

ARTICOLO	F mm	G mm	H mm	J mm	K mm	L mm	M mm	O mm	PER ARTICOLI
W 20215	95	56	66	42	60	67	56	43	W 20130
W 20205	99	57	84	29	39	85	59	55	W 20201 W 20203 W 20131

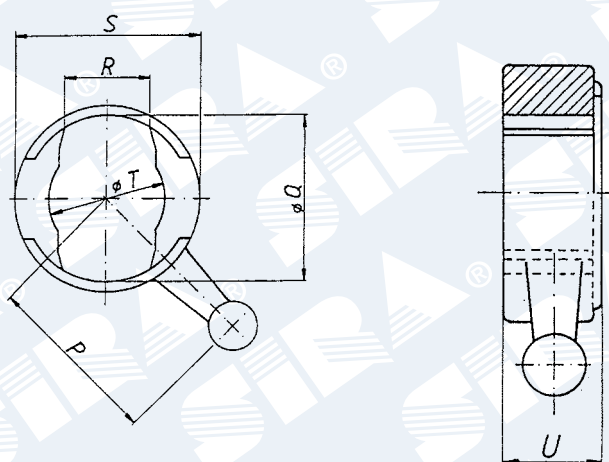

ANELLO DI ARRESTO

ARTICOLO	P mm	Q mm	R mm	S mm	T mm	U mm	PER ARTICOLI
W 20216	106	100	50	113	70	58	W 20130
W 20206	100	105	60	121	86	39	W 20201 W 20203 W 20131

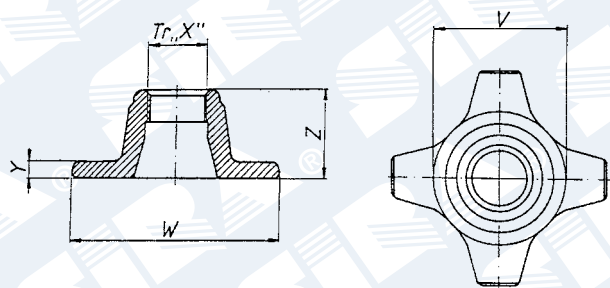

DADO DI SERRAGGIO

ARTICOLO	V mm	W mm	X _{TR} mm	Y mm	Z mm	PER ARTICOLI
W 20217	82	132	38x4	20	82	W 20130
W 20207	83	170	52x5	21	66	W 20201 W 20203 W 20131

COMPONENTI CASSE MOBILI E SCARRABILI

Sistema Schneider - A norme DIN

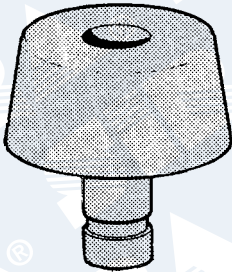

RULLO DI ALLINEAMENTO
IN ACCIAIO

W 20100

5,50 kg

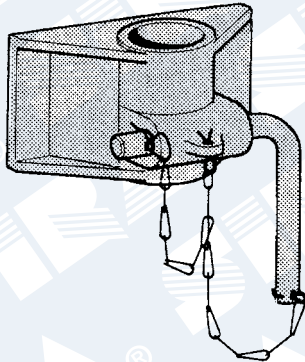
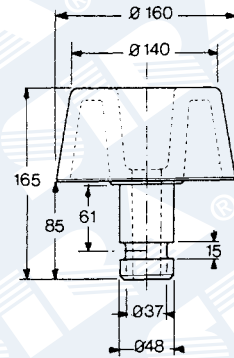

SUPPORTO PER RULLO

W 20110

1,50 kg

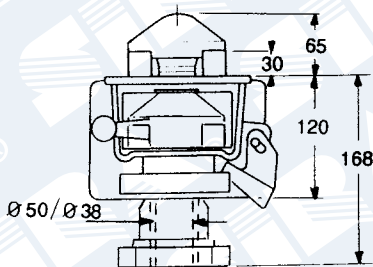
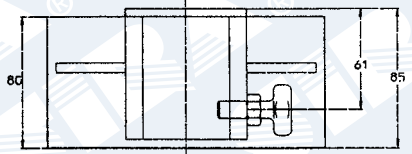
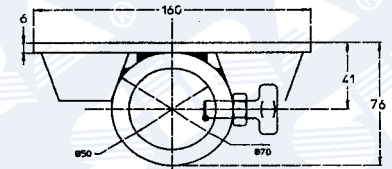

TWIST-LOCK REGOLABILE
PERNO DA 38 mm

W 20130

9,50 kg

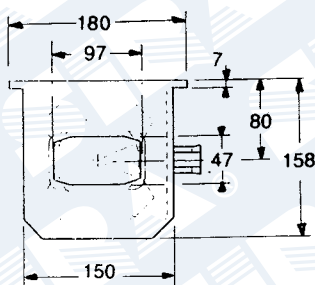
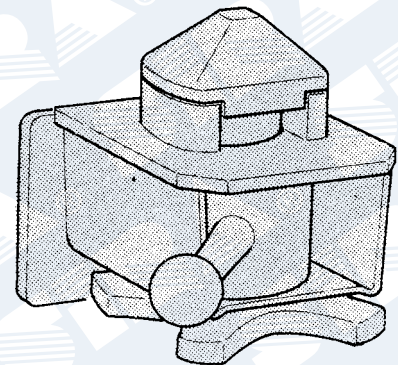

TWIST-LOCK REGOLABILE
PERNO DA 50 mm

W 20131

9,60 kg

COMPONENTI CASSE MOBILI E SCARRABILI

Sistema Schneider - A norme DIN

Disposizione dei particolari sul telaio di un veicolo

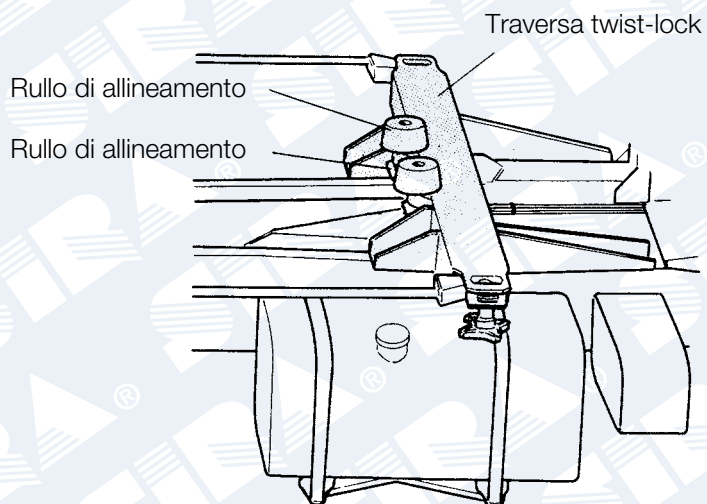
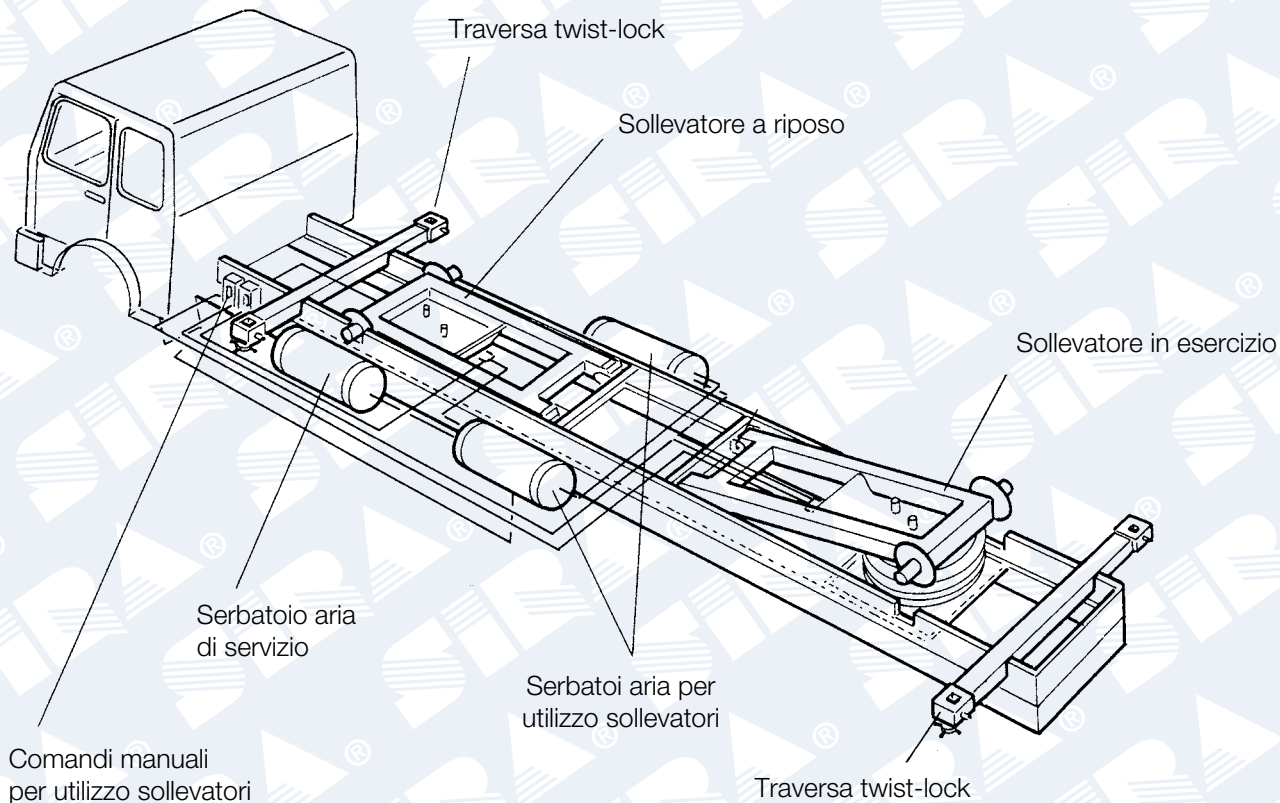

COMPONENTI CASSE MOBILI E SCARRABILI

Sistema Schneider - A norme DIN

Impianto di sollevamento casse mobili

IMPIANTO DI SOLLEVAMENTO
AD ARIA COMPRESSA
PRESSIONE DI ESERCIZIO 8 bar

SOLLEVATORE DA 10 t

W 20140

134,0 kg

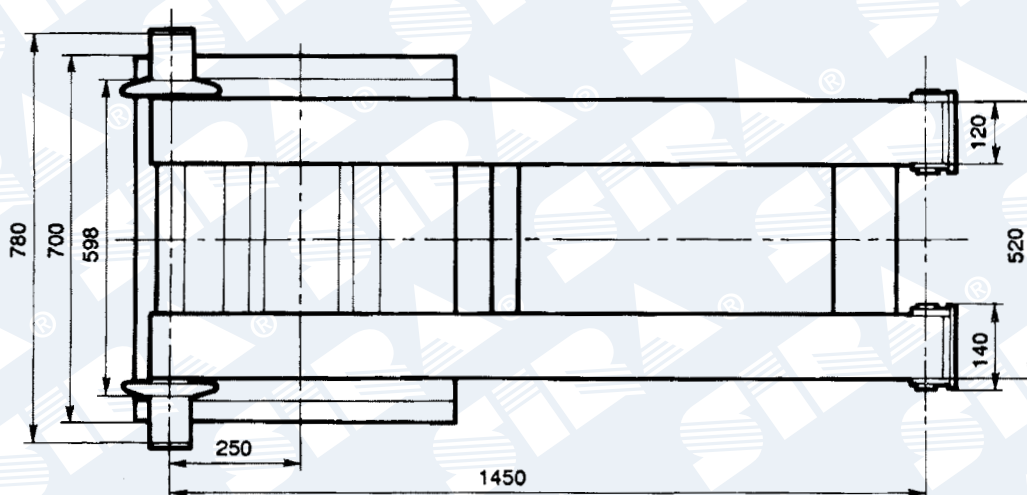
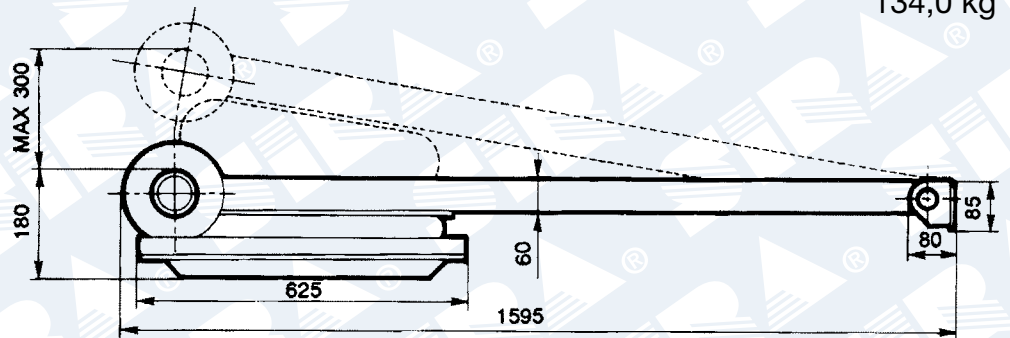

La tenuta d'aria del soffietto del sollevatore è controllata a 6 bar dal produttore. La coppa su cui è imbullonato il soffietto deve essere saldata al telaio del veicolo, smontando prima il soffietto. A saldatura avvenuta, rimontato il soffietto, deve essere ricontrollata la tenuta a 6 bar. La saldatura del sottocoppa al telaio deve essere eseguita a filo discontinuo (tratti di saldatura di circa 80 mm devono essere intercalati a tratti non saldati di circa 100 mm).

COMPONENTI CASSE MOBILI E SCARRABILI

Sistema Schneider - A norme DIN

Componenti per impianto sollevamento casse mobili

KIT CENTRALINA DI COMANDO

W 20150

2,54 kg

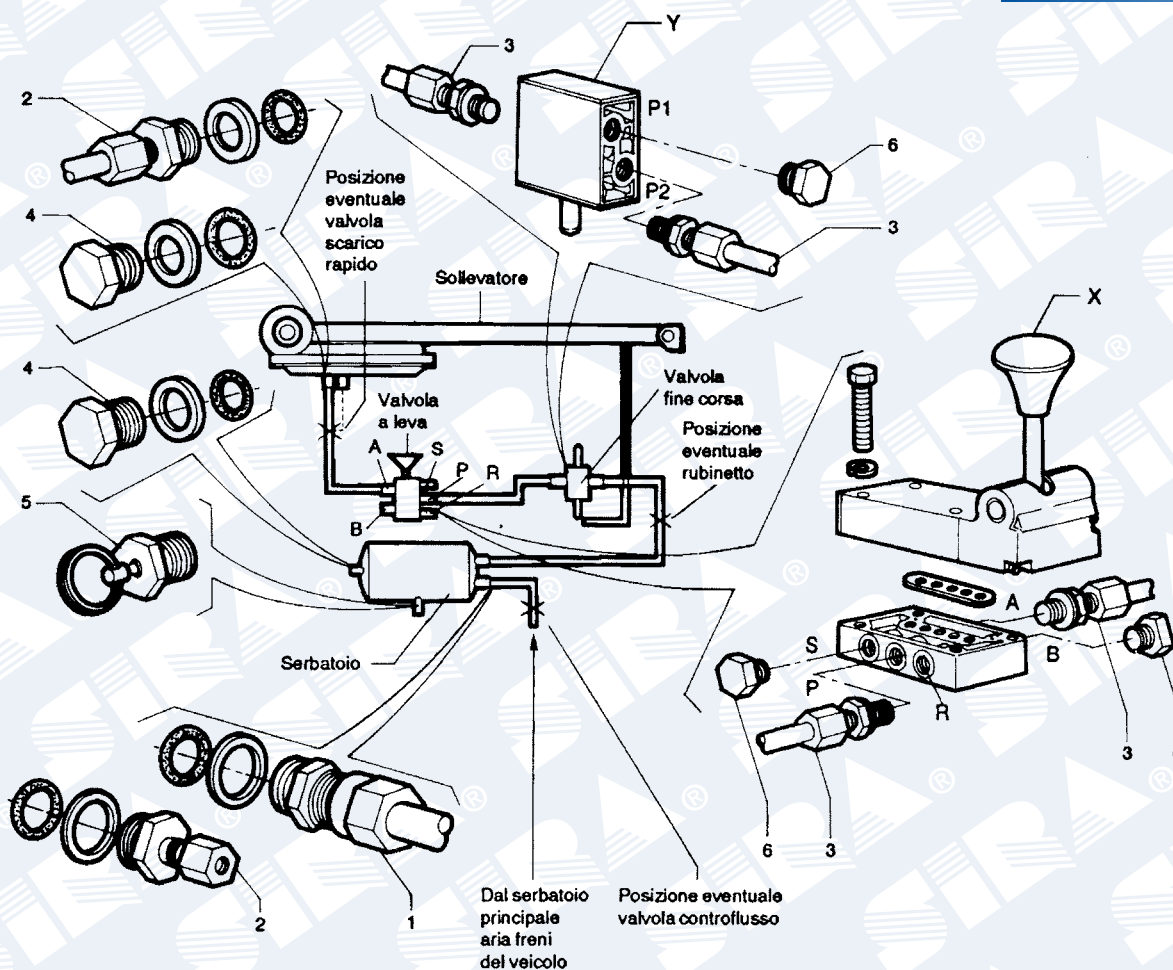

SERBATOIO ARIA 100 litri

W 10160

33,50 kg

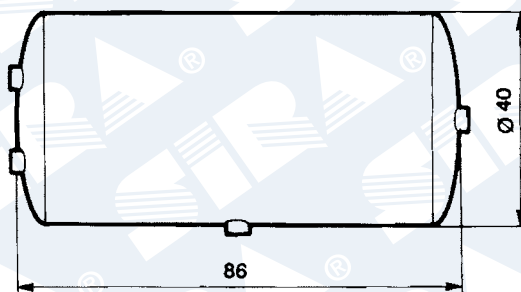

COMPONENTI CASSE MOBILI E SCARRABILI

Ancoraggi containers

L 70221

ANGOLO CONTAINERS
in acciaio GREZZO dx - sx
12 kg

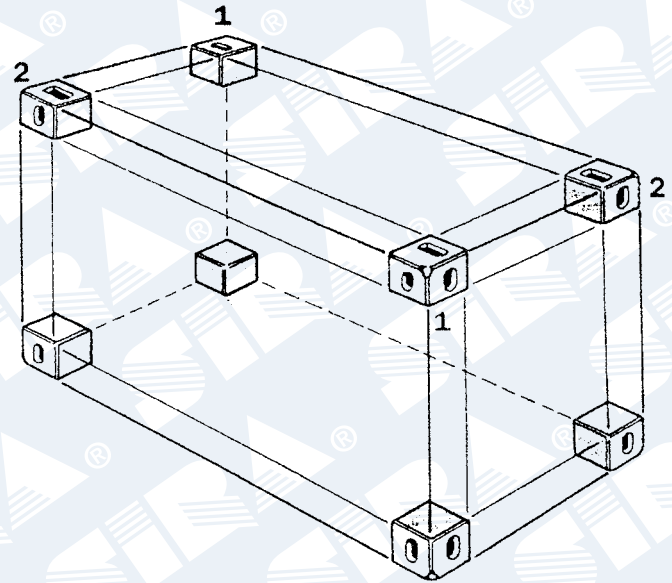
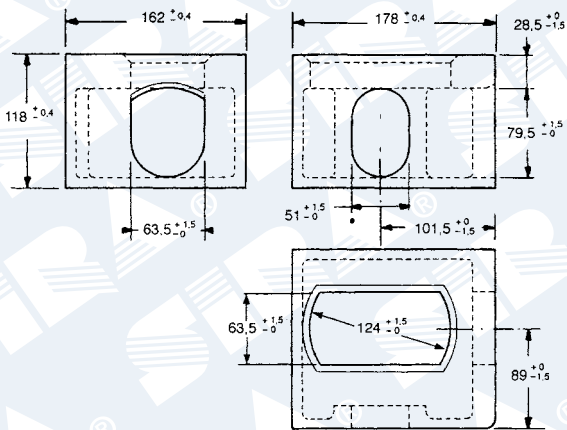
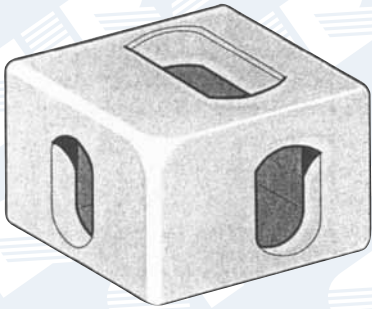

Modello superiore, lato anteriore sx e posteriore dx
Modello inferiore, lato anteriore sx e posteriore dx

L 70220

TWIST-LOCK A SCOMPARSA
COMPLETAMENTE ABBASSABILE
12,6 kg

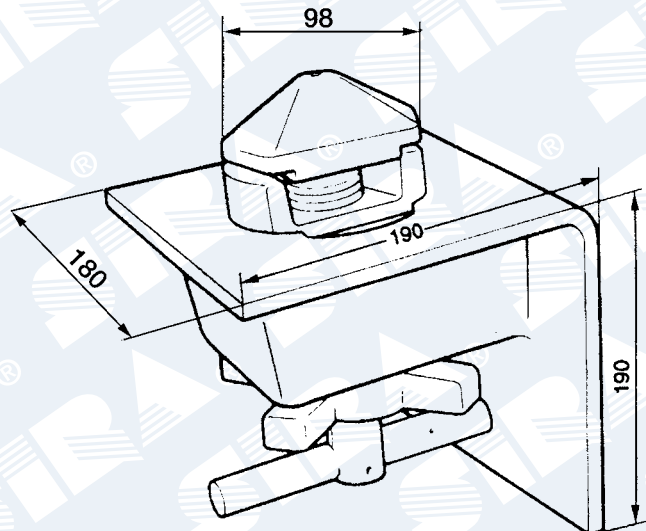

COMPONENTI CASSE MOBILI E SCARRABILI

Ancoraggi scarrabili

DISPOSITIVO DI BLOCCAGGIO

W 10209

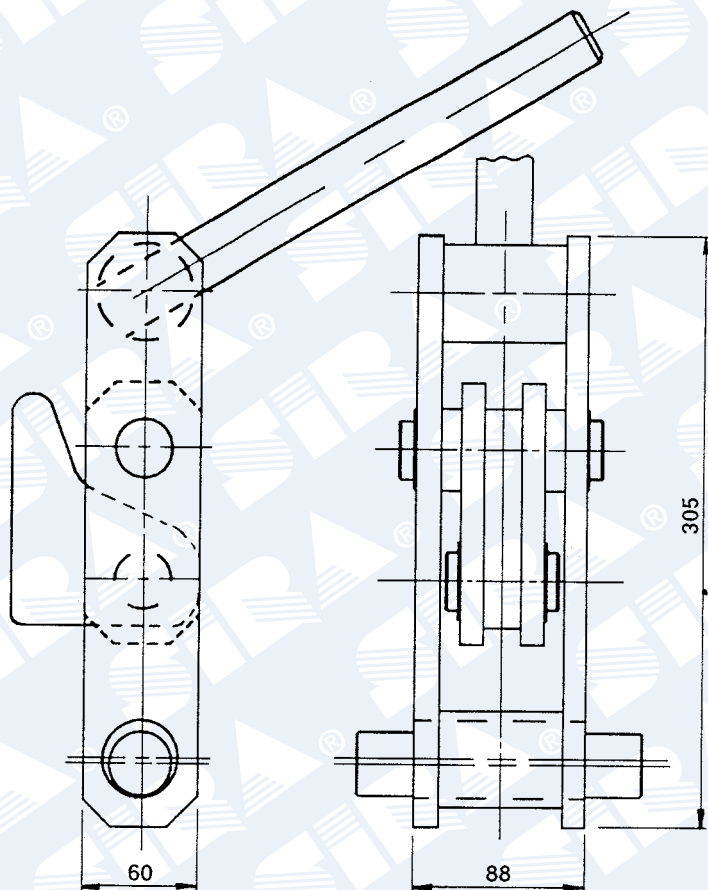

SUPPORTO PER SCONTRO

W 10210

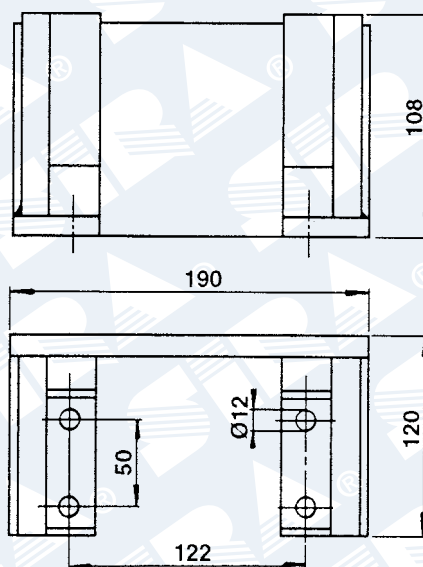

SCONTRO

W 10211

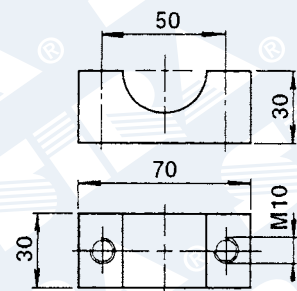

W 10212

SCATOLA DI CENTRAGGIO

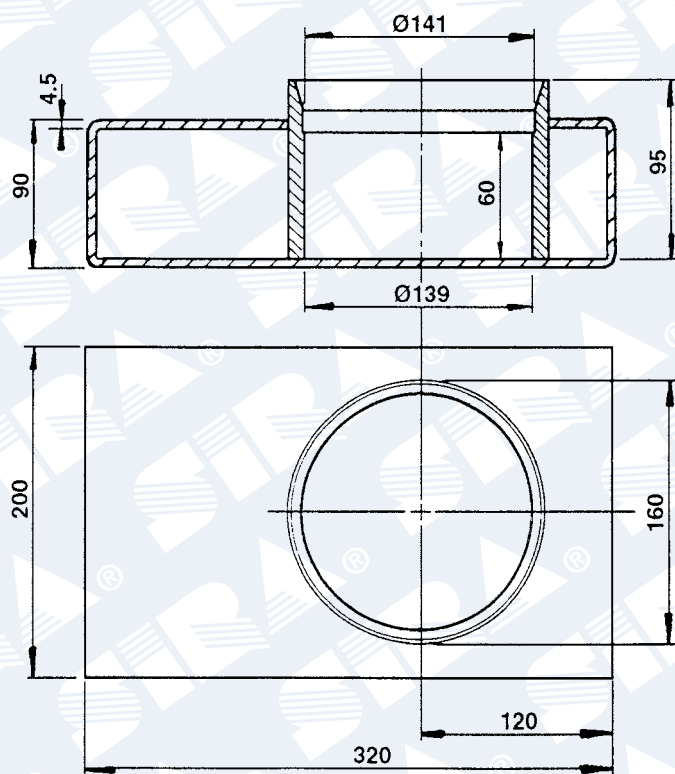

W 10213

CONO DI CENTRAGGIO

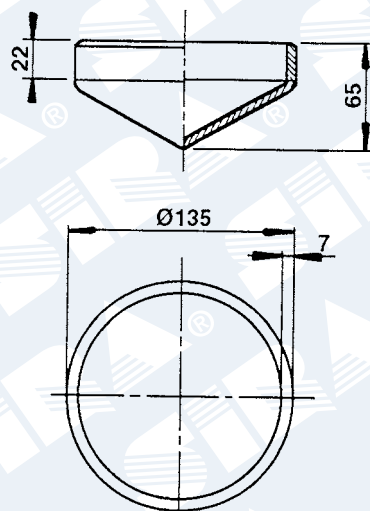

COMPONENTI CASSE MOBILI E SCARRABILI

Componenti varie

PUNTELLO DI RICAMBIO
PER GAMBA

W 20020

6,5 kg

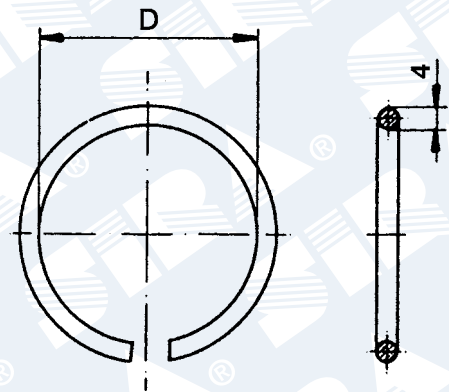
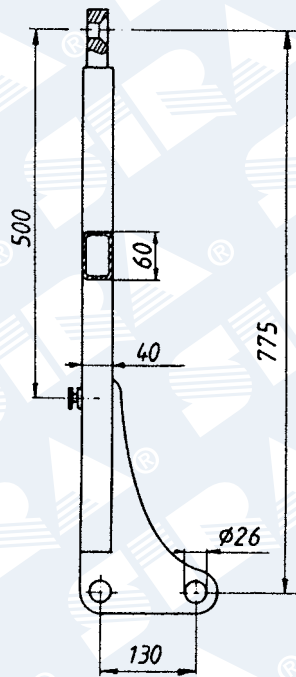

ANELLO DI SICUREZZA

ARTICOLO	D mm	PER ARTICOLI
W 20180	26	W 20130
W 20218	26	W 20130
W 20208	41,5	W 20201 W 20203 W 20131

TOPLESS PER SOLLEVATORE
COMPLETO DI ANELLI

W 20202

2,6 kg

9 kg

